

# Successful with EXJECTION®

## Convincing Examples from Series Implementation

EXJECTION®

© IB STEINER – Oct. 20<sup>th</sup> 2008  
ax08odekt00.fol

[www .exjection .com](http://www.exjection.com)



Powered by  
HYBRID COMPOSITE PRODUCTS GmbH  
and IB STEINER

## TRIM STRIP

Main dimensions: 900 mm x 25 mm x 12 mm (l x w x h)

Wall thickness: 3 mm

Part weight: ca. 76 g

Applied material SAN

Number of cavities: 1

Clamp force demand:

- Conventional injection moulding: 6.500 kN
- EXJECTION®: 550 kN

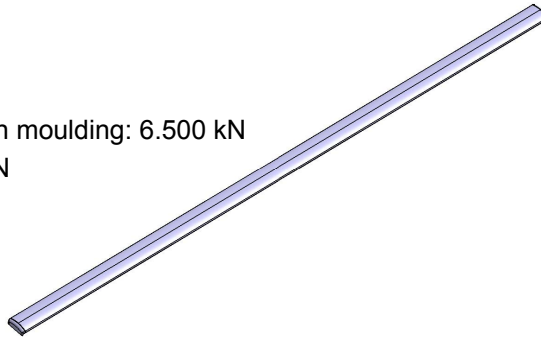

EXJECTION® - Injection Moulding in a new Dimension

© IB STEINER – ax08odekt00.tol – Oct. 20<sup>th</sup> 2008  
Geistiges Eigentum von IB STEINER / intellectual property rights by IB STEINER

## TRIM STRIP

| COMPONENT                      | UNIT      | INJECTION<br>MOULDING | EXJECTION® |
|--------------------------------|-----------|-----------------------|------------|
| <b>Investment</b>              |           |                       |            |
| Machine                        | EUR       | 370.000               | 146.000    |
| Mould                          | EUR       | 105.000               | 124.000    |
| Total                          | EUR       | 475.000               | 270.000    |
| <b>Investment Ratio</b>        | <b>%</b>  | <b>100</b>            | <b>57</b>  |
| Production costs (Invest inc.) | EUR/ Pcs. | 0,79                  | 0,55       |
| <b>Production Cost Ratio</b>   | <b>%</b>  | <b>100</b>            | <b>70</b>  |

EXJECTION® Benefits:

- Significantly reduced investment volume: -43 %
- Significantly reduced production costs: -30 %
- Reduced internal stress level with improved surface quality  
Suitable for back moulding processes (decor films)

EXJECTION® - Injection Moulding in a new Dimension

© IB STEINER – ax08odekt00.tol – Oct. 20<sup>th</sup> 2008  
Geistiges Eigentum von IB STEINER / intellectual property rights by IB STEINER

## CONTROL STRIP

Main dimensions: 660 mm x 25 mm x 13 mm (l x w x h)

Wall thickness: 2,5 mm

Part weight: ca. 80 g

Applied material: ABS

Number of cavities: 1

Clamp force demand:

- Conventional injection moulding: 5.000 kN
- EXJECTION®: 550 kN



EXJECTION® - Injection Moulding in a new Dimension

4

[www.exjection.com](http://www.exjection.com)

© IB STEINER – ax08odekt00.tol – Oct. 20<sup>th</sup> 2008  
Geistiges Eigentum von IB STEINER / Intellectual property rights by IB STEINER

## CONTROL STRIP

| COMPONENT                      | UNIT      | INJECTION<br>MOULDING | EXJECTION® |
|--------------------------------|-----------|-----------------------|------------|
| <b>Investment</b>              |           |                       |            |
| Machine                        | EUR       | 340.000               | 146.000    |
| Mould                          | EUR       | 80.000                | 125.000    |
| Total                          | EUR       | 420.000               | 271.000    |
| <b>Investment Ratio</b>        | <b>%</b>  | <b>100</b>            | <b>65</b>  |
| Production costs (Invest inc.) | EUR/ Pcs. | 0,58                  | 0,51       |
| <b>Production Cost Ratio</b>   | <b>%</b>  | <b>100</b>            | <b>88</b>  |

EXJECTION® Benefits:

- Significantly reduced investment volume : -35 %
- Significantly reduced production costs : -12 %
- Post treatment / rework avoided
- Reduced warpage

EXJECTION® - Injection Moulding in a new Dimension

5

[www.exjection.com](http://www.exjection.com)

© IB STEINER – ax08odekt00.tol – Oct. 20<sup>th</sup> 2008  
Geistiges Eigentum von IB STEINER / Intellectual property rights by IB STEINER

## COVER

Main dimensions: 1.600 mm x 90 mm x 40 mm (l x w x h)

Wall thickness: 1,0 mm

Part weight: ca. 200 g

Applied material: PP

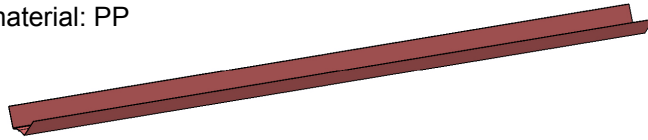

Number of cavities: 1

Clamp force demand:

- Conventional injection moulding: 10.000 kN
- EXJECTION®: 1.500 kN

EXJECTION® - Injection Moulding in a new Dimension

© IB STEINER – ax08odekt00.tol – Oct. 20<sup>th</sup> 2008  
Geistiges Eigentum von IB STEINER / intellectual property rights by IB STEINER

## COVER

| COMPONENT                      | UNIT      | INJECTION<br>MOULDING | EXJECTION® |
|--------------------------------|-----------|-----------------------|------------|
| <b>Investment</b>              |           |                       |            |
| Machine                        | EUR       | 550.000               | 270.000    |
| Mould                          | EUR       | 120.000               | 190.000    |
| Total                          | EUR       | 670.000               | 460.000    |
| <b>Investment Ratio</b>        | <b>%</b>  | <b>100</b>            | <b>69</b>  |
| Production costs (Invest inc.) | EUR/ Pcs. | 0,89                  | 0,81       |
| <b>Production Cost Ratio</b>   | <b>%</b>  | <b>100</b>            | <b>91</b>  |

EXJECTION® Benefits:

- Significantly reduced investment volume: -31 %
- Significantly reduced production costs: -9 %
- Improved surface quality
- Material savings due to reduced wall thickness

EXJECTION® - Injection Moulding in a new Dimension

© IB STEINER – ax08odekt00.tol – Oct. 20<sup>th</sup> 2008  
Geistiges Eigentum von IB STEINER / intellectual property rights by IB STEINER

## Calculation Basis

- Machine costs for 1 component, standard injection moulding machine without special equipment considered
- Machine investment includes EXJECTION® license costs
- Amortization period for moulding machines: 8 years
- Amortization period for moulds: 5 years
- For calculation of hourly rates a 3 shift working pattern has been considered

EXJECTION® - Injection Moulding in a new Dimension

8

[www.exjection.com](http://www.exjection.com)

© IB STEINER – ax08odekt00.tol – Oct. 20<sup>th</sup> 2008  
Geistiges Eigentum von IB STEINER / intellectual property rights by IB STEINER

## Your Contact to EXJECTION®



**IB STEINER**

Innovation Business  
Poststrasse 12  
A-8724 Spielberg  
Tel.: + 43 / 35 12 / 72 77 6 - 0\*  
Fax.: + 43 / 35 12 / 72 77 6 – 6  
Email: [exjection@ibsteiner.com](mailto:exjection@ibsteiner.com)



EXJECTION®  
Partners:

**ARBURG**

**BÖHLER**  
EDELSTAHL



**ENGEL**  
be the first.

**CAD-Plast GmbH**  
Kunststofftechnik  
Innovationen in der Kunststoffverarbeitung

**DEMA**  
Engineering

**goldflow**  
Injection Moulding

**KISTLER**  
measure. analyze. innovate.

**cerlikon**  
balzers coating

Supported by



**FFG**

EXJECTION® - Injection Moulding in a new Dimension

9

[www.exjection.com](http://www.exjection.com)

© IB STEINER – ax08odekt00.tol – Oct. 20<sup>th</sup> 2008  
Geistiges Eigentum von IB STEINER / intellectual property rights by IB STEINER